

KAUAERANGA FOREST EDUCATION CAMP



A LODGE FOR EDUCATIONAL AND RECREATIONAL USE

Fees: per night

Adult \$20

Child \$15

(Pre-schoolers free)

Primary/High school groups \$350

Minimum Charge \$200

Deposit/Bond to confirm booking \$300



What to bring with you.

- Warm bedding and pillows
- First aid kit
- Torches
- Food
- Dishwashing and cleaning materials (eco-friendly please)
- Rubbish bags
- Toilet paper
- Tea towels
- Warm clothes
- Lawn chairs
- Games
- Lanterns for evening outdoors
- Matches/lighters
- Sketch pad journal (optional)

Please read the green camp folder upon arrival for detailed information.

Kitchen & Dining room.

- Gas cooking (six elements, Large hot plate)
- Gas hot water
- Cutlery, crockery, pots, pans kettles for 46 people.
- Table and chairs
- Open fire (Limited wood)
- Large pantry space
- Two gas fridges
- Library (feel free to donate books)
- Five picnic tables for outdoor dining



Bedrooms

46 beds are Available

- Four with 9 bunks
- Two with 3 bunks
- One with 4 bunks (larger beds off the main hall kitchen area)

NO CANDLES NO SMOKING,

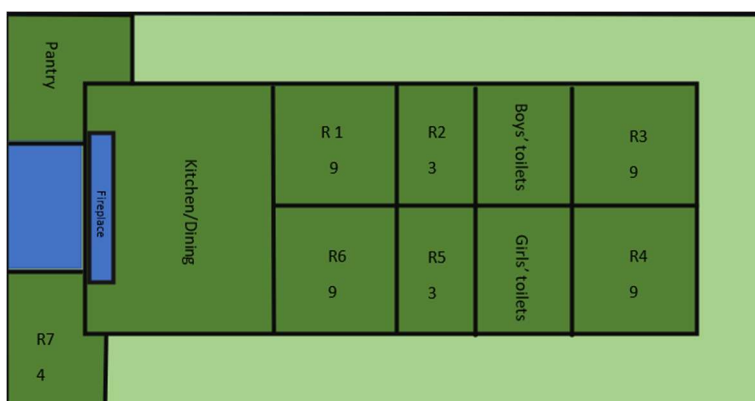

LIGHTING.

12V Solar/wind system -Modern, efficient LED lighting in all rooms. Bedrooms and Bathrooms have new TIMER switches – they will switch off automatically. Please do not tamper with these

THE FINAL DAY:

It is your responsibility to check all equipment is accounted for. A checklist is kept in the green folder in the kitchen. Please put kitchen equipment back in correct drawers & cupboards.

A cleaning checklist is also in this folder. Please leave the Camp cleaner than you found it - there will be another group after yours.

We will come & check your clean up at the time you arrange.

Any removed, broken equipment or Graffiti will be charged against your BOND.

if another group is booked in after you check out will be at 11am

WATER SUPPLY.

This is a gravity fed supply. Filter tap available, all other water boil before drinking.

GENERATOR.

A petrol-operated generator to run audio/visual equipment is available. Advise us if you need to use this.

EMERGENCIES. The nearest phone is at the

DOC Visitor Centre - hours are 8.30-4pm or a payphone outside the building. You will find Spark and Vodafone reception at random places with some phones around the camp.

RUBBISH.

Please recycle – Glass –(Plastic 1&2 only) -Cardboard – Cans facility provided.

We can dump your rubbish for \$7 per black bag. Please let us know if you need this service.

CONSIDERATIONS.

- Extreme care is needed on the Kauaeranga Valley Road
- Never attempt crossing flooded fords to get out of Valley - they go down as quickly as they came up, so just wait it out!
- No camping allowed within Lodge Grounds
- Fire arms are not permitted
- Put fireguard around open fire before retiring or leaving
- Leave the Camp cleaner than you found it
- Cut kindling for incoming groups and fill box with firewood

NO DOGS ALLOWED



Things to Do:

The Kauaeranga Visitor Centre is a great place to start! Staff will show a short movie about the history of the area, and can give talks to school groups on request. Snacks, drinks and supplies are available from the visitors' centre, however for main items you can pick up from the local Pak n save or kauaeranga valley store.

Swimming holes, rock hopping, large playing field, nearby hikes, day walks and off-site areas for those into mountain biking or abseiling.

Come escape technology, relax and listen to the sound of nature.

Please visit <http://www.doc.govt.nz/kauaeranga> for information on walks in the Valley. - Swimming holes



How to find us?

As you come into Thames from the South, turn right at the BP station onto Banks Road. Stay on this road as it turns into Parawai, then Kauaeranga Valley Road. After 14km, you will come to the DoC Visitor Centre. Drive past this for another 8km. Directly after the Wainora Bridge (this used to be a ford, for those who have stayed with us before)

you will take a left up a hill and into the Education Camp grounds.

The other option is to type Kauaeranga valley Education camp into google maps which will give you the estimated time.

(if you type in kauaeranga forest education camp it will take you to the D.O.C visitors centre)

Valley weather can be very changeable. Come prepared for another nights stay



WE WISH YOU AN ENJOYABLE STAY!

Get in Touch

President: Shane Rapley – 021-858-864

Wardens: Michelle & Cain - 07-8687283

Reservations and payments:

Michelle & Cain 07-8687283

995b Kauaeranga Valley Rd RD2 Thames

k.f.educationcamp@gmail.com

Did you take something of ours home?

Please return to 995B Kauaeranga Valley Road RD2 Thames 3577 as soon as you can.